



M2

125W x 2 Channel Power Amplifier

Installation & User Guide

SAFETY INSTRUCTIONS

	CAUTION RISK OF ELECTRIC SHOCK DO NOT OPEN	
CAUTION: To reduce the risk of electric shock, do not remove cover, (or back). No user serviceable parts inside. Refer servicing to qualified service personnel.		



The lightning flash with arrowhead symbol, when in an equilateral triangle, is intended to alert the user to the presence of in-insulated "dangerous voltage" within the product's enclosure that may be of sufficient magnitude to constitute a risk of electric shock to persons.



The exclamation point, within an equilateral triangle, is intended to alert the user to the presence of important operating and maintenance (servicing) instructions in the literature accompanying the appliance.

APPLICABLE FOR USA, CANADA OR WHERE APPROVED FOR USAGE
CAUTION: TO PREVENT ELECTRIC SHOCK, MATCH WIDE BLADE PLUG TO WIDE SLOT, INSERT FULLY
ATTENTION: POUR EVITER LES CHOCS ELECTRIQUES, INTRODUIRE LA LAME LA PLUS LARGE DE LA FICHE DANS LA BORNE CORRESPONDANTE DE LA PRISE ET POUSSER JUSQU'AU FOND

Read all of these instructions before operating and save instructions for later use.

1. **Read Instructions** – All the safety and operating instructions should be read before the appliance is operated.
2. **Retain Instructions** – The safety and operating instructions should be retained for future reference.
3. **Heed Warnings** – All warnings on the appliance and in the instructions should be adhered to.
4. **Follow Instructions** – All operating and use instructions should be followed.
5. **Water and Moisture** – The appliance should not be used near water – for example, near a bathtub, washbowl, kitchen sink, laundry tub, in a wet basement or near a swimming pool.

PORTABLE CART WARNING



6. **Carts and Stands** – The appliance should be used only with a cart or stand that is recommended by the manufacturer. An appliance and cart combination should be moved with care. Quick stops, excessive force, and uneven surfaces may cause the appliance and cart combination to overturn.
7. **Wall or Ceiling Mounting** – The appliance should be mounted to a wall or ceiling only as recommended by the manufacturer.
8. **Ventilation** – The appliance should be situated so that its location or position does not interfere with its proper ventilation. For example, the appliance should not be situated on a bed, sofa, rug, or similar surface that may block the ventilation openings; or, placed in a built-in installation, such as a bookcase or cabinet that may impede the flow of air through the ventilation openings.
9. **Heat** – The appliance should be situated away from heat sources such as radiators, heat registers, stoves, or other appliances (including amplifiers) that produce heat.
10. **Power Sources** – The appliance should be connected to a power supply only of the type described in the operating instructions or as marked on the appliance.
11. **Grounding or Polarization** – Precautions should be taken so that the grounding or polarization means of an appliance is not defeated.
12. **Power-Cord Protection** – Power-supply cords should be routed so that they are not likely to be walked on or pinched by items placed upon or against them, paying particular attention to cords at plugs, convenience receptacles, and at the point where they exit from the appliance.
13. **Cleaning** – The appliance should be cleaned only as recommended by the manufacturer.
14. **Power Lines** – An outdoor antenna should be located away from the power lines.
15. **Nonuse Periods** – The power cord of the appliance should be unplugged from the outlet when left unused for a long period of time.
16. **Object and Liquid Entry** – Care should be taken so that objects do not fall and liquids are not spilled into the enclosure through openings.
17. **Damage Requiring Service** – The appliance should be serviced by qualified service personnel when:
 - A. The power-supply cord or the plug has been damaged; or
 - B. Objects have fallen, or liquid has spilled into the appliance; or
 - C. The appliance has been exposed to rain; or
 - D. The appliance does not appear to operate normally or exhibits a marked change in performance; or
 - E. The appliance has been dropped or the enclosure damaged.
18. **Servicing** – The user should not attempt to service the appliance beyond that described in the operating instructions. All other servicing should be referred to qualified service personnel.

TABLE OF CONTENTS

SAFETY INSTRUCTIONS	2
TABLE OF CONTENTS	3
INTRODUCTION	4
WHAT'S INCLUDED	5
M2 FEATURES	5
FRONT PANEL	6
REAR PANEL	7
INSTALLATION	8
AIR FLOW	8
SPEAKER PLACEMENT	9
WIRE REQUIREMENTS	10
CONNECTIONS	12
SPEAKER CONNECTIONS	10
AUDIO CONNECTIONS	11
Input	11
LOOP	11
AC Power Cord	12
POWER ON/OFF MODES	13
Manual Power (Standby)	13
Audio Sensing (Auto On)	13
LEVEL CONTROL	13
SYSTEM APPLICATIONS	14
Multiroom	15
Home Theater Plus Second Zone	17
Multizone High Power Zone	19
TROUBLESHOOTING	20
SPECIFICATIONS	21
LIMITED 2-YEAR WARRANTY	22
NOTES	23

INTRODUCTION

Congratulations and thank you for purchasing the Proficient Audio M2 Two Channel Power Amplifier.

The M2 combines the best of styling and performance in a truly solid amplifier that can handle just about any high power audio application.

With discreet components and high current output, the M2 delivers clean, powerful sound in any application. Whether used for critical listening in a two-channel music room or crankin' the tunes by the pool, M2 is the perfect amplifier when it's the sound that counts. M2 is right at home adding extra rooms of high powered audio to an A/V Receiver, 2 zone surround receiver or multiroom audio controller.

For systems where high powered audio is needed in multiple rooms, the M2 Loop Output can be used to connect up to four additional M2s for up to five rooms of high powered amplified audio.

With 125 Watts per channel, (235W @ 4Ω) of power, the individual channel Level Controls can be set to maximum output levels to protect the amp, and the speakers, from driving the amp to clipping or driving the speakers to improper levels.

Optional Audio Sensing automatically turns the M2 ON and OFF with the rest of the system. Simply turn on the A/V Receiver, play a source and get ready to experience the power of the Proficient M2.

The M2 is more than a solid performer, it looks good too. The cast aluminum Front Panel is like no other and makes an impressive addition to any stack of gear.

Fully Featured. Solid Performer. Great Looking. Home entertainment never looked and sounded this good.

Please read and follow the instructions in this guide to assist in proper installation connection and use of the Proficient M2 Two Channel Power Amplifier.

WHAT'S INCLUDED

- 1 - M2 Two Channel Audio Amplifier
- 1 - Power Cord
- 1 - M2 Installation & User Guide

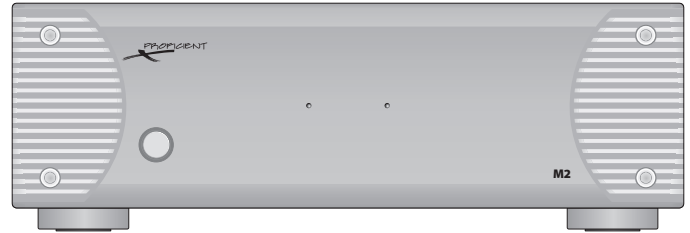

M2 FEATURES

Amplifier

- 125W Continuous x 2 Channels RMS @ 8Ω; 20Hz - 20kHz; 0.01% THD
- 235W Continuous x 2 Channels RMS @ 4Ω; 20Hz - 20kHz; 0.05% THD

Audio Inputs

- Stereo Line Level Audio Input

Outputs

- Four five-way binding posts for speaker connection
- Stereo Loop Out can feed the Line Level Audio Input signal to additional amplifiers

Control

- Manual Power ON/OFF
- Audio Sensing Power ON/OFF
- Individual Input Level adjustments

Front Panel Display

- ON/OFF indicator
- Two hazard (red) LEDs, one for each channel

M2 FRONT PANEL FEATURES

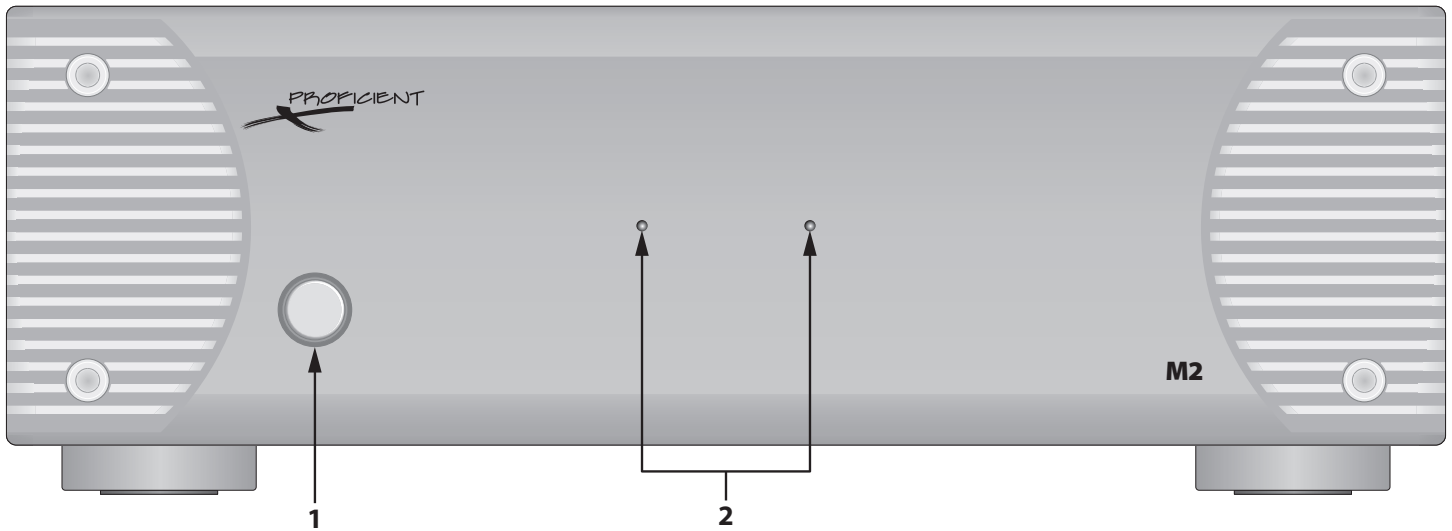

Diagram 1 *M2 Front Panel Features*

FRONT PANEL

- 1. ON/OFF** - Press this button to turn the M2 ON/OFF. (Rear Panel Audio Sense switch set to STANDBY.) When OFF, the button backlight is OFF. To turn the unit ON, press the button. The ON/OFF button backlight and both Front Panel LEDs will illuminate blue. The M2 will go through a power up sequence of about five seconds after which the amplifier will output audio to connected speakers from a connected, playing audio source. To turn the unit OFF, press the button again. The audio signal will be cut, the amp will turn off, the Front Panel LEDs and the ON/OFF button backlight will turn OFF.
- 2. FRONT PANEL LEDs** - (Two multicolored LEDs) These LEDs illuminate blue when the M2 is connected to AC power and the amplifier is ON. Both will illuminate even if there is no audio signal output from one channel, to indicate proper amplifier function. A specific channel LED will turn red if that channel has shut down due to thermal overload, short circuit or other improper operating condition.

M2 REAR PANEL FEATURES

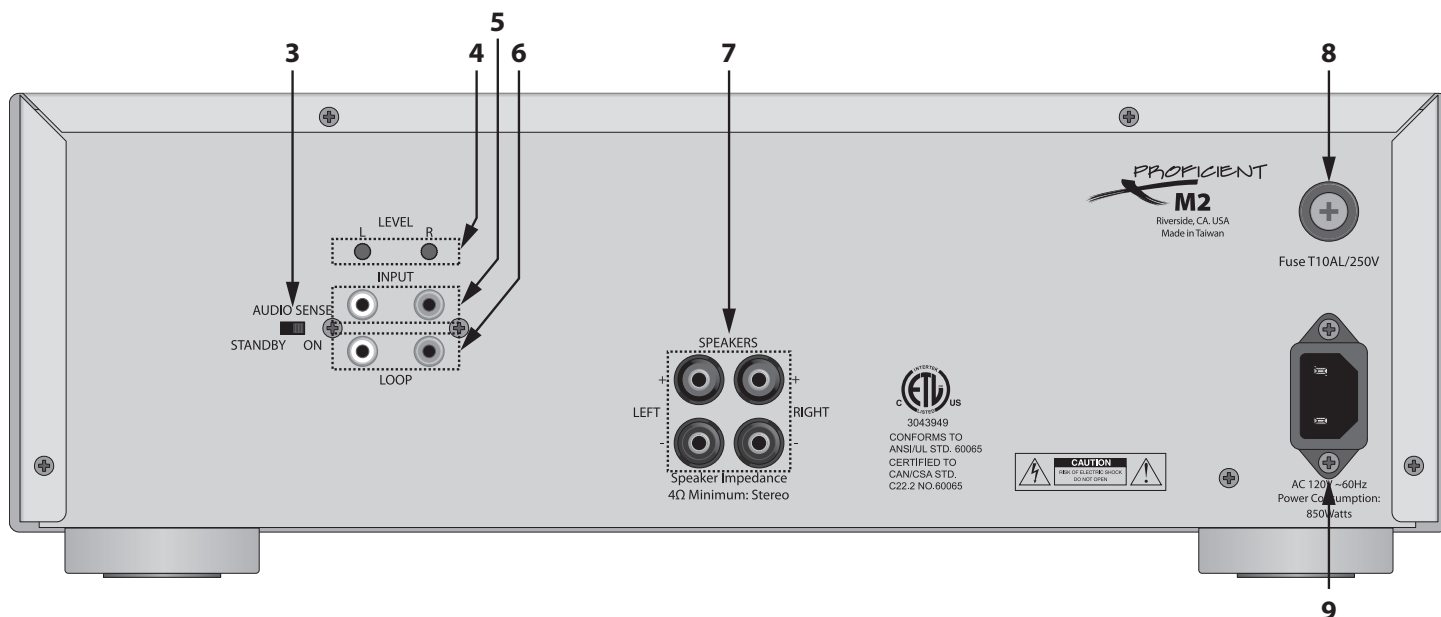

Diagram 2 M2 Rear Panel Features

REAR PANEL

- 3. AUDIO SENSE** - (One, two position switch) Configure this switch to set the power ON/OFF mode for the M2. The M2 can be turned ON/OFF in two ways: manually pressing the ON/OFF button on the Front Panel (Standby) or Audio Sensing which will turn the amp ON when an audio signal is present on either input and turn it OFF when no audio signal has been sensed for 5 minutes.
- 4. LEVEL** - (Two, recessed controls) Turn these knobs to independently raise or lower the volume of each channel. Turn counterclockwise (left) to lower the channel output, turn clockwise (right) to raise channel output. These controls can be used to adjust balance for a stereo pair or set a maximum output level to prevent the amplifier from clipping or damaging the speakers from playing at too high a level.
- 5. LINE IN** - (Two, RCA jacks) Connect to the line level output of an audio source that is to be amplified as two mono channels or a stereo pair.
- 6. LOOP** - (Two RCA jacks) Connect to the INPUT on up to four additional M2s to add additional rooms of high powered amplified audio for the connected audio source. LOOP is a fixed, (non-variable) line level audio output.
- 7. SPEAKER TERMINALS** - (Four, five way binding posts) Connect to the left and right speaker + and - terminals.
- 8. FUSE** - Replaceable T10AL/250V fuse.
- 9. AC INPUT** - Connect to the included IEC 2-prong AC Power Cord. After all connections have been made and confirmed, plug the power cord into an unswitched 110V AC Outlet to power the M2. Contact Proficient Audio Systems for a proper replacement should the AC Power Cord be damaged or misplaced.

INSTALLATION

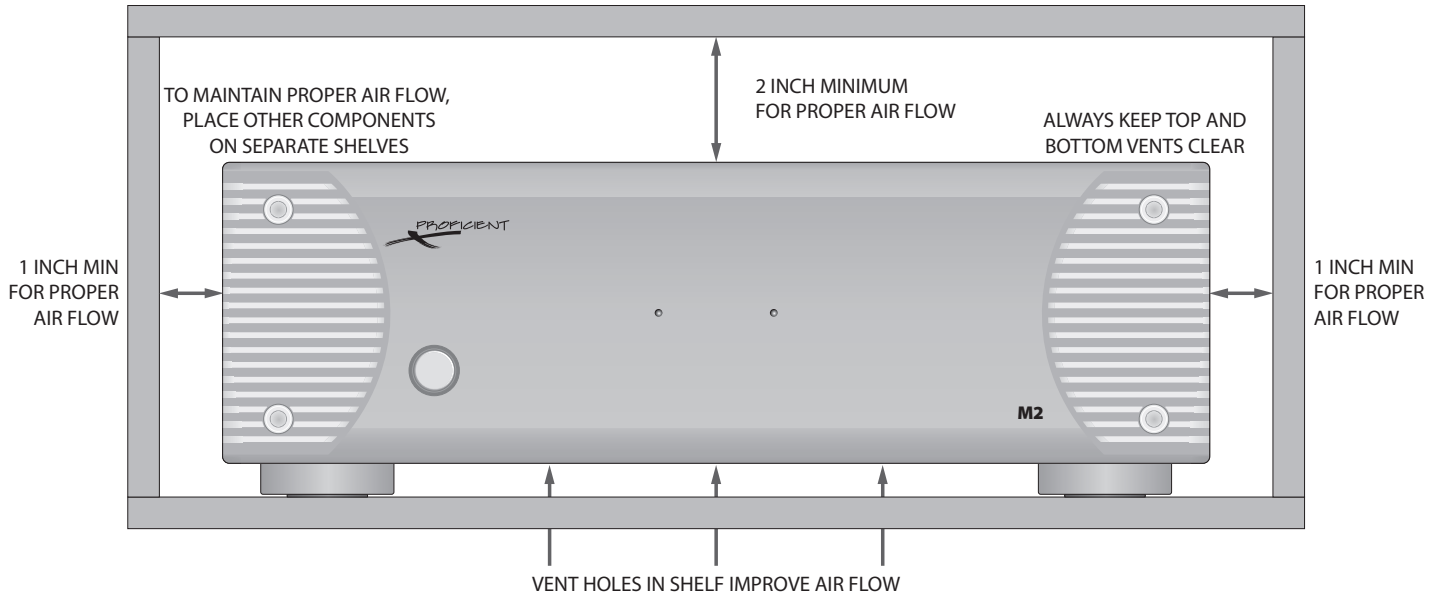

Diagram 3 *M2 Air Flow Requirements*

AIR FLOW

The Proficient M2 is designed to run cool under most normal operating conditions but may run warm at moderate to high output. It is typical for an discreet component, high current amplifier to generate a certain amount of heat dissipation that needs to be properly ventilated.

Closed spaces such as equipment cabinets and racks can get hot with the heat generated by microprocessors and motors in various devices. Providing proper ventilation for good air flow will help keep the temperature down and protect not only the M2 but all system components and help preserve their longevity.

When installing the M2 a few easy steps should be taken to assure proper air flow:

1. Never block the vent holes on the top or bottom of the M2.
2. Never remove the feet on the bottom of the M2.
3. Leave at least 2 inches above and 1 inch on each side of the M2 for free air flow.
4. Whenever possible, provide vent holes in the shelf under the M2 to increase air flow into the bottom of the unit.
5. Leave the back of the cabinet as open as possible for good air circulation.
6. Place other system components on separate shelves.
7. Install fans in cabinets and racks when equipment is generating high heat levels.

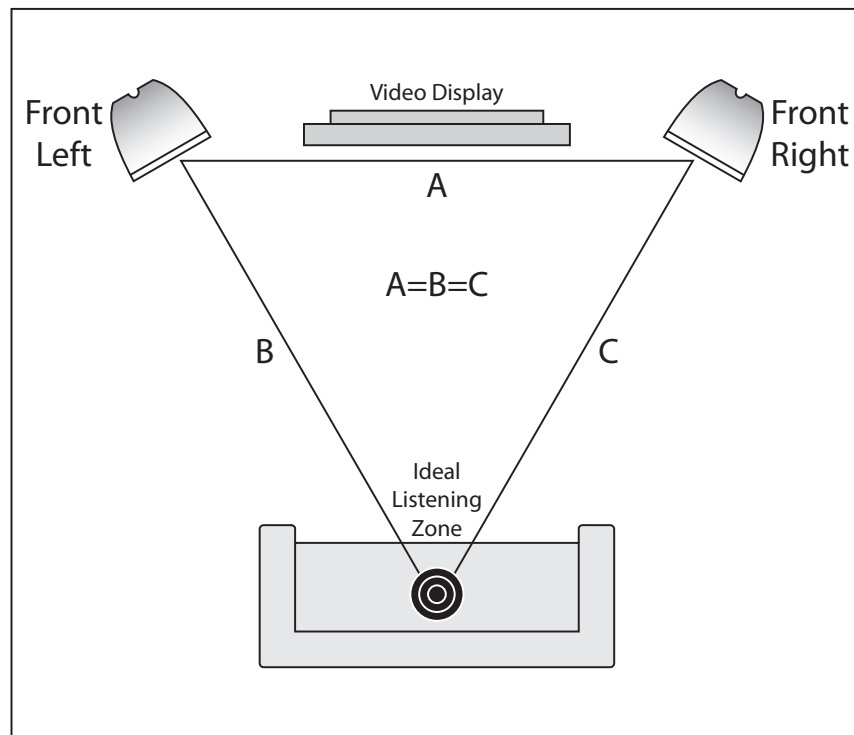

Diagram 4 *Speaker Placement*

SPEAKER PLACEMENT

Use the following recommendations when determining speaker placement.

Determine The Ideal Listening Zone

The area where the user will most likely be sitting when listening to the speakers is the Ideal Listening Zone.

Placement of Stereo Speakers

The distance between the left and right speakers should as closely equal the distance from one speaker to the listener as possible. ($A=B=C$) The left and right speakers should also be equal distances from a TV or Video Display for balance with audio/video content.

Bookshelf Speakers

In audio/video applications when using bookshelf speakers, locating the speakers at the same height as the TV or Video Display and at equal distances to left and right of the Video Display will create an effect where the sound emanates from the picture.

Inwall Speakers

Ideally, speaker placement should be similar to that described for bookshelf speakers. Many brands of inwall speakers, including most Proficient models, have pivoting tweeters that can 'focus' the high frequency content directly to the Ideal Listening Zone and compensate for sometimes less than desirable placement so the sound will still be balanced with the Video Display.

Ceiling Speakers

Ceiling speakers are very popular in modern architecture. Ceiling speakers, like bookshelf or inwall speakers, should be placed at an equal distance from each other and the Ideal Listening Zone. Many Proficient ceiling speakers have pivoting tweeters that can 'focus' the high frequency content directly to the Ideal Listening Zone and compensate for sometimes less than desirable placement so the sound will still be balanced with the Video Display.

INSTALLATION

WIRE REQUIREMENTS

Use the following recommendations for speaker wire runs.

Speaker Wire

If connecting the M2 for multiroom audio, pull two pair of speaker wires from the M2 location directly to each speaker in home runs, (each run direct from the M2 to each speaker).

1. Pull 1 run of 16AWG (min) 2-conductor stranded speaker wire from the M2 location to each speaker in a home run configuration. Leave extra length (24 inches) on both ends to work with when making connections. (4-conductor wire can be used by running the 4-conductor wire to an entry point in the room and then splitting into two runs of 2-conductors, one run (pair) to each speaker.)

In new construction, the wires should be pulled before the dry-wall is installed. In retro-fit applications, (existing construction) the wires will need to be pulled through the walls and holes will need to be cut in the drywall for the speakers. It is highly recommended that an audio/video installation professional be hired to do this type of work. Contact the retailer that the M2 was purchased from for information on professional installation.

Use the **Speaker Wire Length Chart** to determine the proper wire gauge based on actual overall wire length from the M2 to the speaker pair it will be driving.

SPEAKER WIRE LENGTH	SPEAKER WIRE GAUGE
150' (46m)	16 AWG
400' (122m)	14 AWG
1000' (305m)	12 AWG

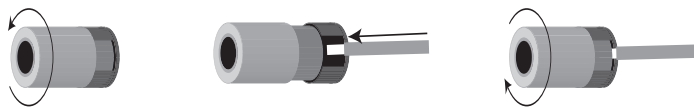

Diagram 5 Bare Wire Connections

SPEAKER CONNECTIONS

1. Use 16AWG (min) 2-conductor stranded speaker wire for speaker connection. (Refer to the **Speaker Wire Length Chart** for wire runs over 150')
2. Strip approximately 1/2 to 3/4 of an inch off the ends and twist the strands together so there are no loose ends that can cause shorts.
3. Loosen the Left Channel Speaker + and - Terminals as shown in **Diagram 5** so there is enough room between the post and the collar to feed the striped wire through without damaging the strands.
4. Tighten the post to secure the wire.
5. Repeat for the Right Channel + and - Terminals.
6. Confirm connection and polarity.
7. Connect the speaker wires to the appropriate left and right + and - terminals on the speakers. **Diagram 6**
8. Confirm connection and polarity.

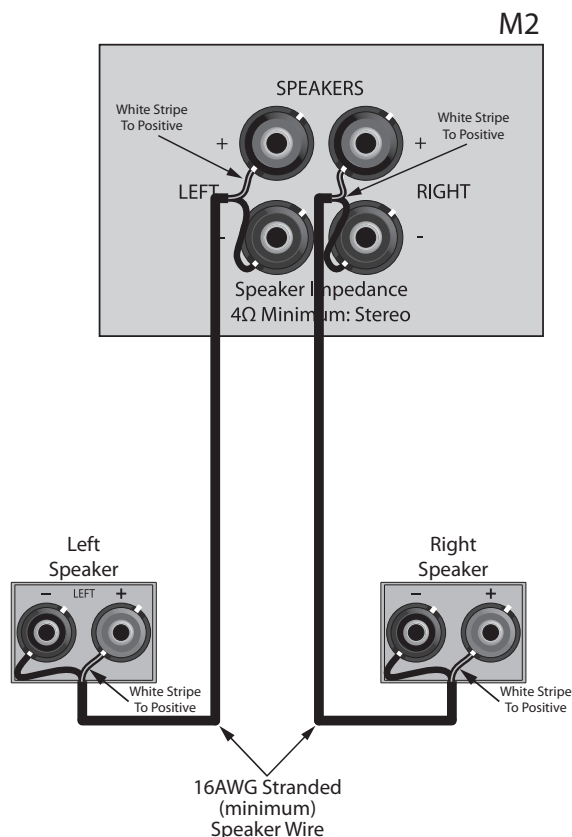

Diagram 6 M2 Normal Mode Speaker Connections - Multiroom

AUDIO CONNECTIONS

The M2 has one stereo audio input. It allows connection of up to two mono sources or one stereo source.

Input

1. Using a stereo RCA patch cable with gold ends, connect the L & R line level audio OUT of a stereo audio source to the Left and Right INPUT jacks on the M2. For mono, connect individual RCA mono cables to either jack for two mono sources or connect a Y adaptor to a mono RCA cable to feed a single mono source to both M2 inputs.

Diagram 7

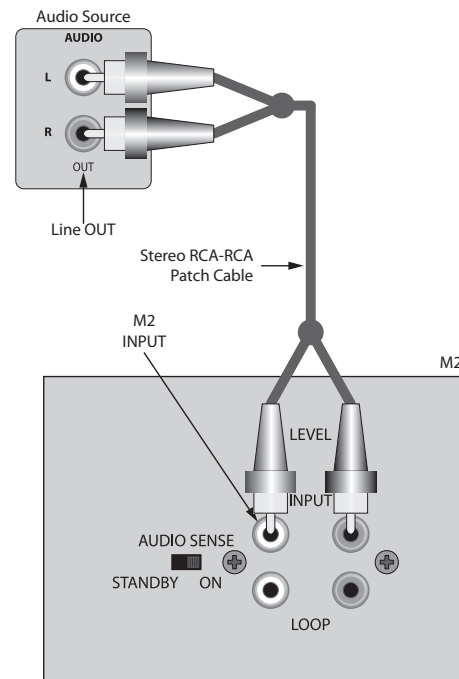

Diagram 7 M2 Audio Input Connections

LOOP

To expand audio distribution for the source(s) connected to the INPUT, to more than two mono outputs or one stereo output, the LOOP can be connected to up to four additional M2s.

Diagram 8

1. Using a stereo patch cable with gold ends, connect LOOP on M2 #1 to the INPUT on M2 #2.
2. Repeat **Step 1** for all additional M2s. (Five M2s total.)

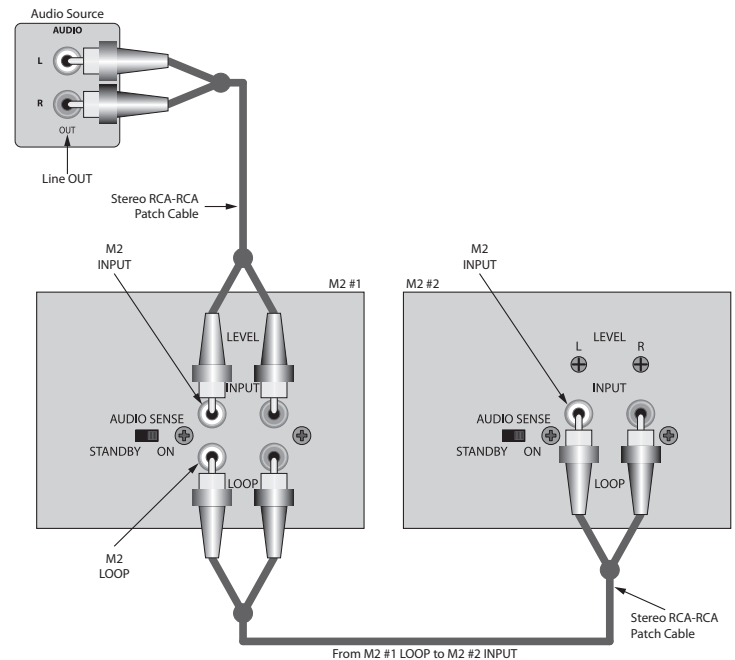

Diagram 8 M2 Audio Input/LOOP Audio Connections

CONNECTIONS

AC Power Cord

1. After all connections have been made and confirmed, connect the female IEC plug into the AC Input on the M2 Rear Panel and then plug the AC power cord into an unswitched 110V AC outlet. **Diagram 9**

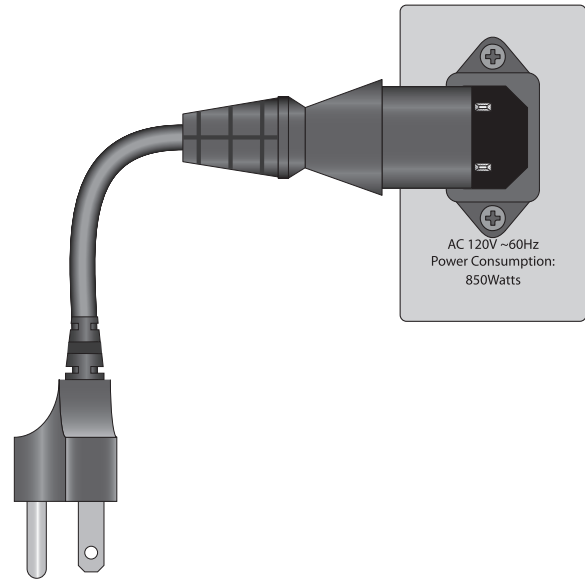

Diagram 9 AC Power Cord Connections

POWER ON/OFF MODES

The M2 can be configured for two power ON/OFF Modes: Manual (Standby) and Audio Sensing.

Manual Power (Standby)

Manual power mode requires pressing the ON/OFF button on the Front Panel to turn the M2 ON/OFF. One press of the button will turn the amplifier ON. Another press will turn the amplifier OFF.

1. Set the Audio Sense switch to STANDBY as shown in **Diagram 10**. No further configuration is required.
2. To test, with the M2 connected to an unswitched 110V AC outlet, press the ON/OFF button on the Front Panel. The ON/OFF button backlight and both front Panel LEDs will turn ON (blue). After a few seconds the amplifier will output audio from a connected, playing source. To turn OFF, press the button again, the audio will be cut, the ON/OFF button backlight and Front Panel LEDs will turn OFF.

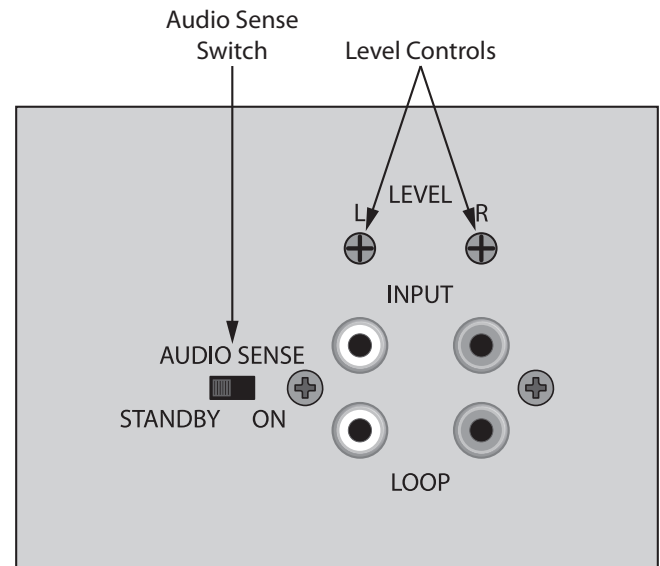

Diagram 10 M2 Manual Power (Standby) and Level Controls

Audio Sensing (Auto On)

Audio sensing will turn the M2 ON when an audio signal is present on the INPUT. When an audio signal is detected, the amplifier will turn ON. When no audio signal is detected for 5 minutes, the amplifier will turn OFF.

1. Set the Audio Sense switch to ON as shown in **Diagram 11**.
2. Set the M2 Front Panel ON/OFF button to the ON (in) position.
3. Connect an audio source to the INPUT to act as a trigger for audio sensing.

4. To test, with the M2 and audio source connected to un-switched 110V AC outlets, activate the audio source and play content, (CD, Tuner, etc). The ON/OFF button backlight and Front Panel LEDs will turn ON (blue). After a few seconds the amplifier will output audio from the connected, playing source. To turn OFF, stop the audio output from the audio source. After 5 minutes of no audio input, the M2 will turn OFF. (The ON/OFF button backlight and Front Panel LEDs will all turn OFF.)

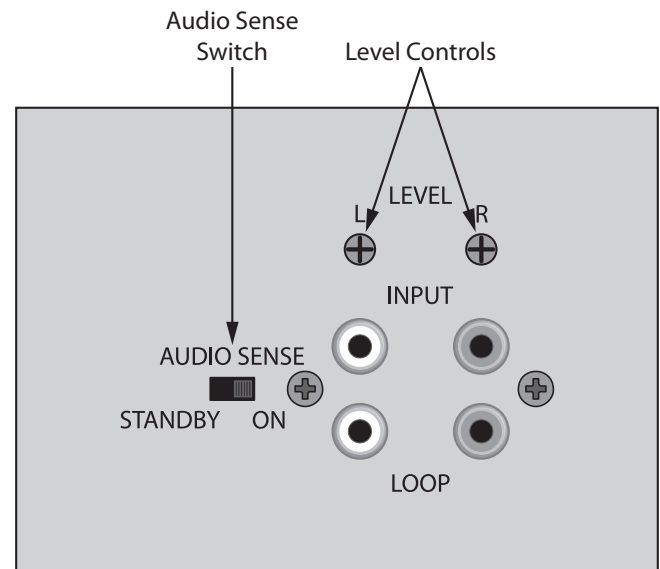

Diagram 11 M2 Audio Sense and Level Controls

LEVEL CONTROL

The Level Controls are effective for setting a maximum output level. This will help prevent the amp from clipping and also protect the speakers from damage by being driven to improper levels. The Level Controls can also be used to balance stereo audio when speaker placement is less than ideal. See section: **Speaker Placement** for additional information.

1. With the system OFF, using a small blade or phillips screwdriver, set the M2 Level Controls to the center detente (click) position.
2. Turn the system ON and play a source (CD, Tuner, etc.)
3. To adjust M2 Level Controls, turn the recessed Level Controls counterclockwise (left) to reduce level. Turn the controls clockwise (right) to increase level.
4. Slowly raise the master volume on the receiver or zone controller until audio is playing through the M2 at a moderate level. Confirm audio output from the connected speakers.
5. Alternately using the master volume control on the receiver or zone controller and M2 Level Controls, in small steps, continue to raise the master volume and make adjustments to the M2 Level Controls to set a maximum output level. As master volume is raised, monitor output level and distortion. Be careful not to damage the M2 or speakers.
6. When finished making adjustments, set the master volume control to a normal listening level.

SYSTEM APPLICATIONS

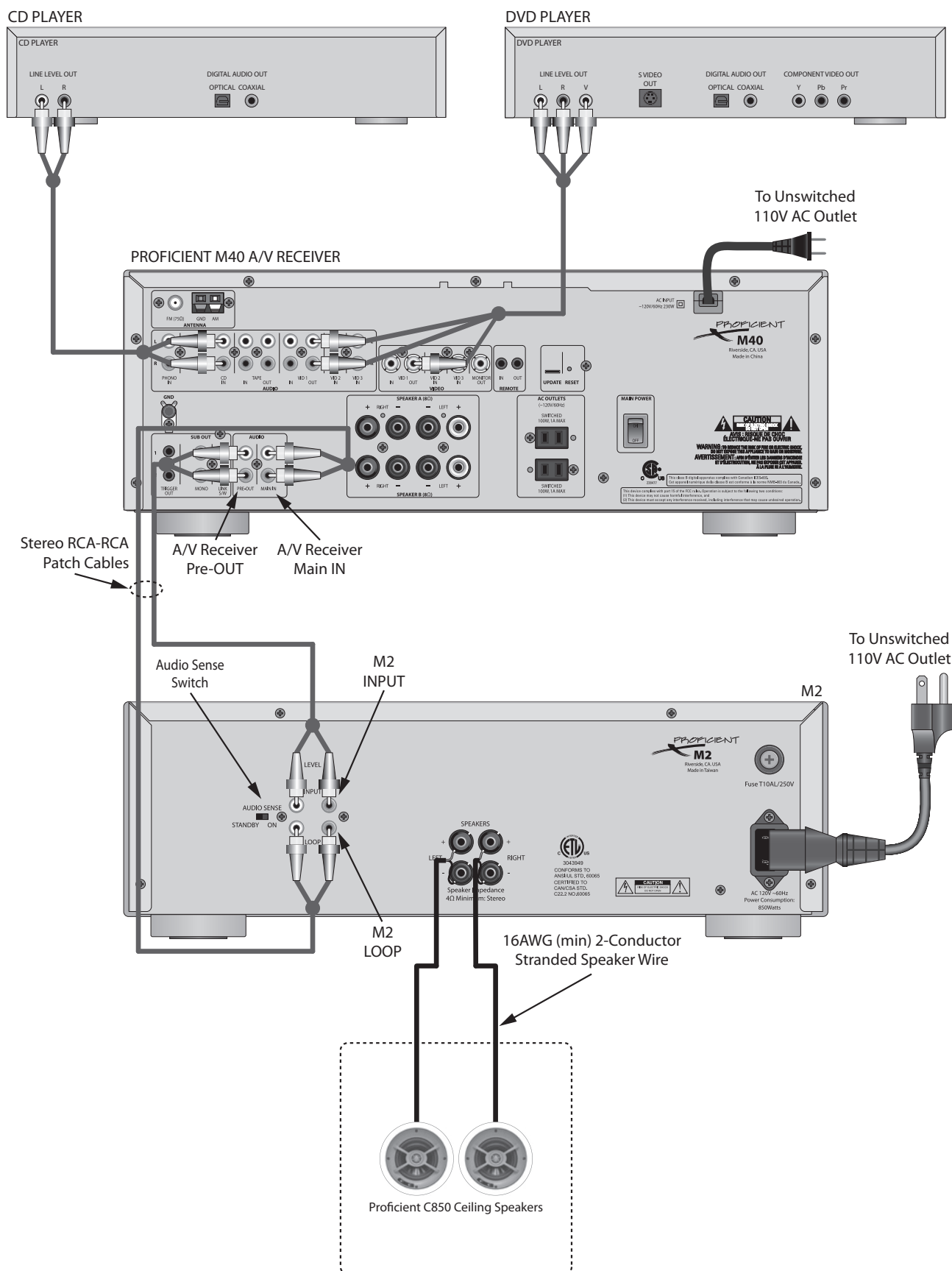

Diagram 12 M2 Multiroom System

SYSTEM APPLICATIONS

The following pages will provide three M2 system examples: multiroom, home theater with a second zone and a high powered zone in a multizone system. These are by no means the only uses for this amplifier. The M2 can be used for just about any application where high powered audio amplification is required. For assistance with M2 applications, please call Proficient Audio Technical Support at 877.888.9004 or email techsupport@proficientaudio.com. Proficient Tech Support is open every weekday, except holidays, between the hours of 7:00AM and 5:00PM PST.

Multiroom

The multiroom system shown in **Diagram 12** features the M2 when used to add an additional room of high powered amplified audio to an A/V Receiver, (coincidentally a Proficient M40). This system is a single-source system, meaning the same source will be played through all active speakers at the same time. The system shown allows anywhere from one to five rooms of audio depending upon configuration.

Note: The M40 allows direct connection of two pair of speakers, or up to four pair if using impedance matching volume controls. Those speakers/volume controls are not shown in **Diagram 12**. Please refer to the Owners Manual if using another brand receiver for information on speaker connections/limitations.

Audio/Video sources are connected to the M40 Receiver in a normal manner. They are selected and played in a normal manner using the front panel controls or a remote control. When a source is selected it will play through all active speakers. With this type of system, it is best to set a master volume on the Receiver and use the individual room volume controls to adjust volume.

Input

The M2 is connected to the M40 Receiver Pre-Out. The Pre-Out is a variable line level audio output that is connected to the M2 INPUT. The M2 INPUT audio signal will output through the speakers connected to the M2.

1. Connect the M40 Pre-OUT to the M2 INPUT.

Loop

The M2 LOOP is a fixed line level audio output that can be used in a number of different ways. In the example shown, the LOOP is being fed back to the M40 Receiver Main IN. The M40 features a pre-out/main in connection for various purposes. In this case, that connection will be used to insert the M2 into the source audio signal path. That is: when a source is selected, it will output from the M40 Pre-OUT. Via the M2 INPUT connection, the M2 will be fed the source audio signal. LOOP will output that same audio signal back to the M40 Main IN which feeds the M40 amplifier. In this configuration, if the M2 LOOP is not connected to the M40 Main IN, the M40 will not output amplified audio.

1. Connect the M2 LOOP to the M40 Main IN.

The LOOP can also be used to add additional M2 amplifiers for additional rooms of high powered amplified audio. Up to five total M2s can be connected in this manner.

1. Connect the M2 LOOP to the next M2 INPUT. Repeat to connect up to five M2s (5 high powered amplified rooms).

Audio Sense Switch

For convenience, the M2 can be setup to turn ON/OFF manually (Standby) or automatically (Audio Sense) when the M40 is turned ON/OFF. The manual mode should be used if the high power room is only going to be used occasionally, (outdoor area, where it would not be neighborly to crank up the music at 1:00 in the morning). Audio sensing should be used for a room that is to always turn ON/OFF when the M40 is turned ON/OFF.

Manual Power (Standby)

1. Set the Audio Sensing switch to Standby.
2. Turn the M2 ON/OFF as needed by pressing the Front Panel ON/OFF button.

Audio Sensing

Requires no additional connections. When the M2 detects audio at the INPUT it will automatically turn ON.

1. Set the Audio Sense switch to ON.
2. Set the Front Panel ON/OFF button to the ON (in) position.

SYSTEM APPLICATIONS

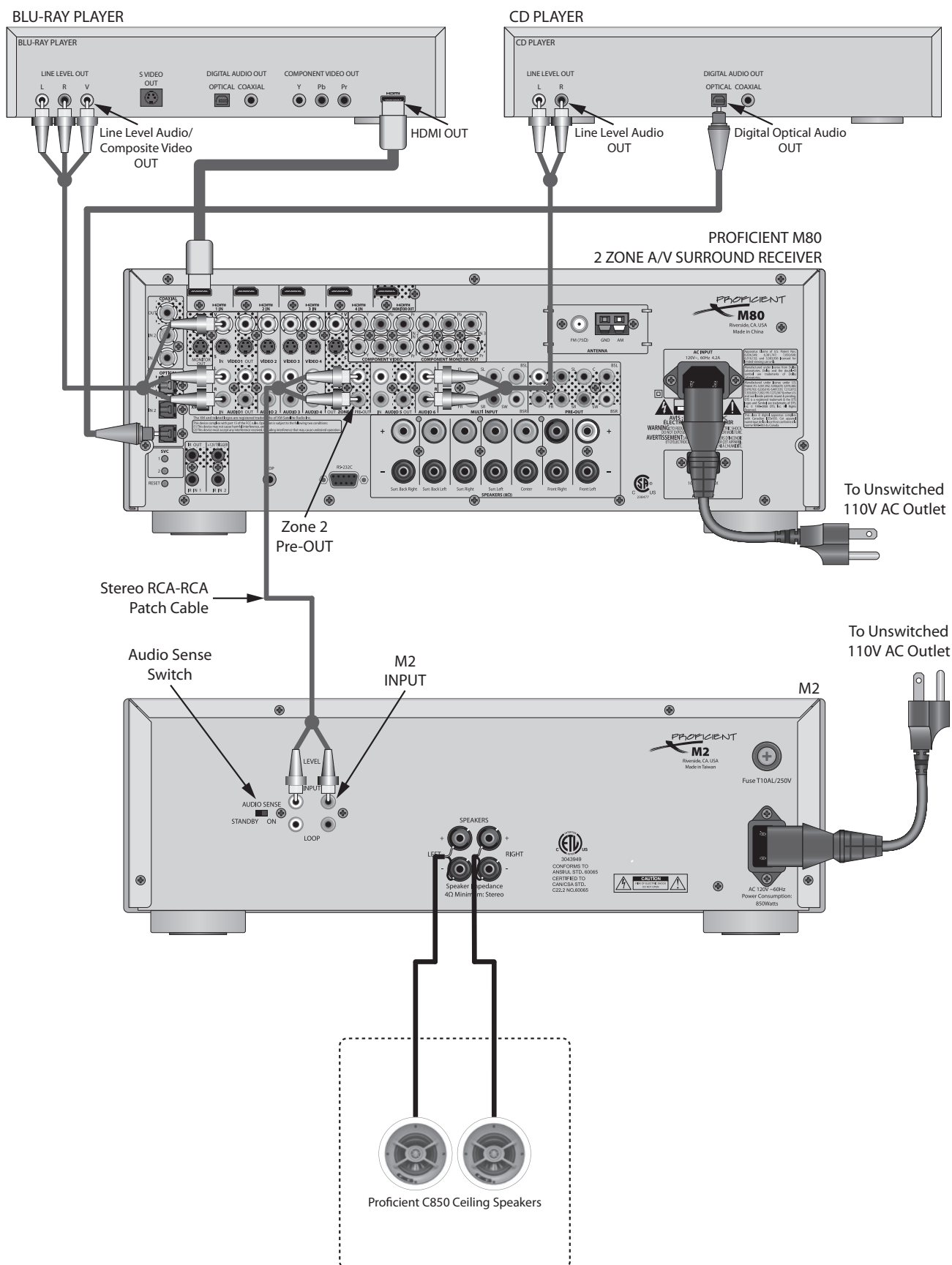

Diagram 13 M2 Home Theater Plus Second Zone System

Home Theater Plus Second Zone

The multizone system shown in **Diagram 13** features the M2 when used to add a room of high powered amplified audio to the Zone 2 OUT on an A/V Receiver, (in this case a Proficient M80). This system is a two zone system, meaning two different sources can be played at the same time. The home theater is Zone 1 and can select any source connected to the M80. The M80 features a Zone 2 OUT that can output line level audio and composite or S-Video. (For purpose of example only the Zone 2 audio connections will be detailed here. Please refer to the **M80 Installation and User Guide** for additional information.)

Note: The M80 allows connection of 5.1 or 7.1 surround speaker configurations. Those speakers are not shown in **Diagram 13**. Please refer to the Owners Manual if using another brand receiver for information on connections/limitations.

M80 Source Connections

Audio/Video sources are connected to the M80 Receiver in a normal manner. In the theater zone, they are selected and played in a normal manner using the front panel controls or a remote control. Sources are typically selected and controlled in Zone 2 using an IR Remote via an IR repeater system. The selected sources can be the same in both zones or a different source in each zone. The source selected by Zone 2 will play to all rooms in Zone 2.

The M80 features analog and digital audio and video inputs. Any of these inputs can be selected by the home theater. Zone 2 can only select analog audio inputs, therefore any source that is to be played in Zone 2, must have analog audio connections to the M80.

Input

The M2 is connected to the M80 Receiver Zone 2 Pre-Out. The Zone 2 Pre-Out is a variable line level audio output that is connected to the M2 INPUT. The M2 INPUT audio signal will output through the speakers connected to the M2.

1. Connect the M80 Zone 2 Pre-OUT to the M2 INPUT.

Loop

Source selection and audio processing for the home theater zone and Zone 2 are completely independent. The M80 Zone 2 Pre-OUT is a dedicated line level audio output. It is not necessary to feed the M2 LOOP back to the M80.

The LOOP can also be used to add additional M2 amplifiers for additional rooms of high powered amplified audio. Up to five total M2s can be connected in this manner.

1. Connect the M2 LOOP to the next M2 INPUT. Repeat to connect up to five M2s (5 high power amplified rooms).

Audio Sense Switch

For convenience, the M2 can be setup to turn ON/OFF automatically when M80 Zone 2 is turned ON/OFF.

Audio Sensing

Requires no additional connections. When the M2 detects audio at the INPUT it will automatically turn ON.

1. Set the Audio Sense Switch to Auto ON.
2. Set the Front Panel ON/OFF switch to the ON (in) position.

SYSTEM APPLICATIONS

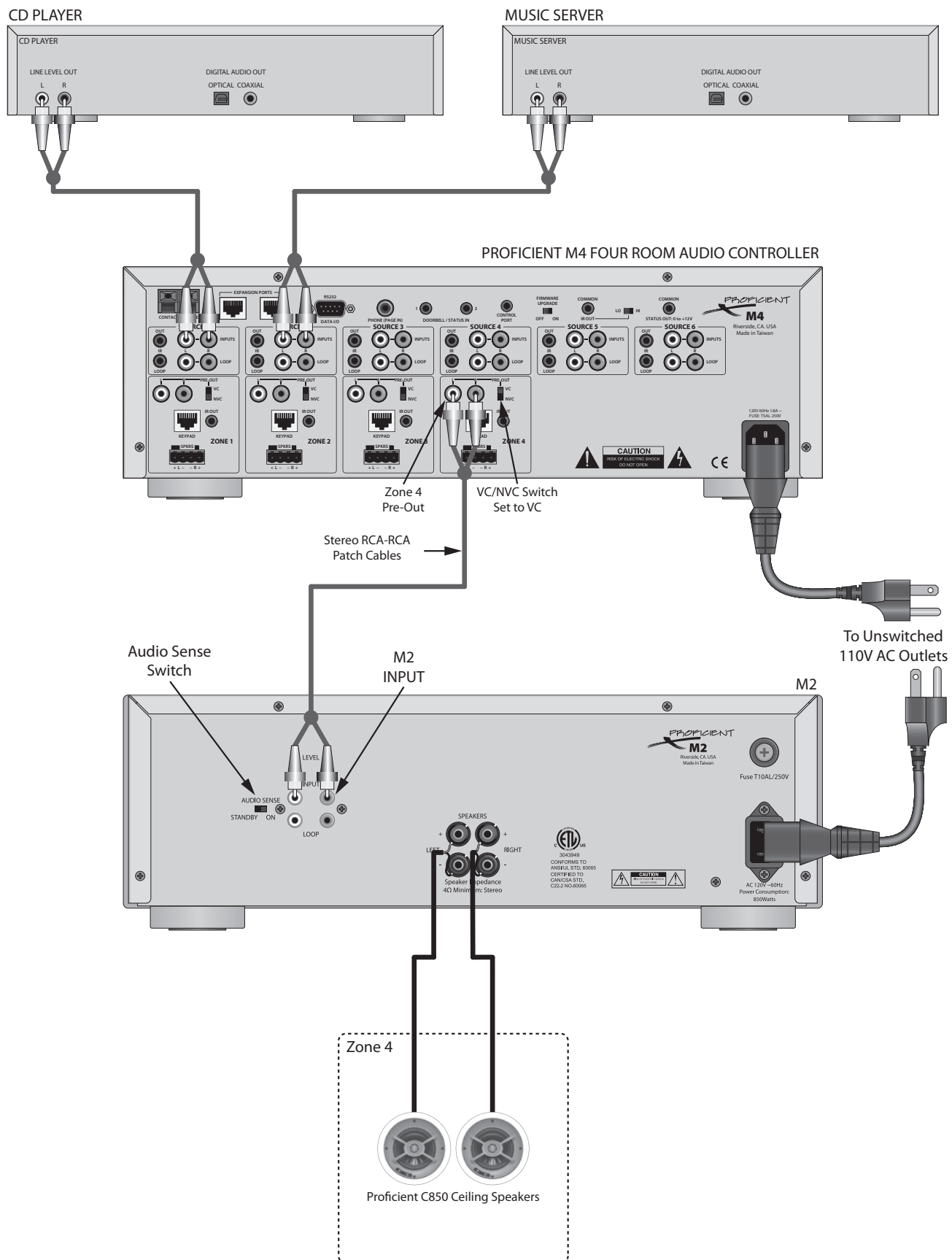

Diagram 14 M2 Multizone High Power Zone Application

Multizone High Power Zone

The multizone system shown in **Diagram 14** utilizes the M2 for a high power zone with a Proficient M4 Multiroom Audio Controller. The M4 allows independent ON/OFF, source selection and volume control by zone. Each zone features it's own amplifier that typically gets connected to a dedicated pair of speakers for that zone.

Note: The speakers that would typically be connected to Zones 1, 2 and 3 are not shown in **Diagram 14**.

Each Zone on the M4 Multiroom Audio Controller features a dedicated zone Pre-OUT. It can be used, as shown in the example, to output line level audio for the source selected in that zone to an external amplifier. The amp could be a high power two-channel amp or a multichannel amp. In this case, the M2 will be used to create a high power zone.

Adding a High Power Zone

Zone 4 is a large room using large speakers with high power handling capability and requires a high powered amp to fill the room to a good sound level.

Input

The M4 Zone 4 Pre-Out is connected to the M2 INPUT. The M4 Zone 4 audio signal will output through the speakers connected to the M2.

1. Connect the M4 Zone 4 Pre-OUT to the M2 INPUT.
2. Set the M4 Zone 4 VC/NVC (volume control/no volume control) switch to VC. Volume will be adjusted using the M4 Zone 4 keypad or remote control.

Audio Sense Switch

For convenience, the M2 can be setup to turn ON/OFF automatically when M4 Zone 4 is turned ON/OFF.

Audio Sensing

Requires no additional connections. When the M2 detects audio at the INPUT it will automatically turn ON.

1. Set the Audio Sense Switch to Auto ON.
2. Set the M2 Front Panel ON/OFF switch to the ON (in) position.

TROUBLESHOOTING

PROBLEM	SOLUTION
Power	
Unit does not power up.	<ul style="list-style-type: none">a) Confirm Power Cord is plugged in to an unswitched 110V AC Outlet.b) If using audio sensing, confirm connection and audio output from audio source. Confirm Audio Sense switch is set to ON. Also confirm ON/OFF button is in the ON (in) position.c) Check Fuse.
Audio	
No Sound From Speakers	<ul style="list-style-type: none">a) Confirm volume is turned up and un-muted.b) Confirm source is selected, turned on and playing.c) Confirm source audio connections.d) Confirm speaker connections.e) Confirm Pre-Out/Main In Jumper connections (A/V Receiver or preamp multiroom system).

SPECIFICATIONS

Audio Sections

Power Output/Channel (Both channels driven into 8 Ω)	125 Watts, 20Hz to 20kHz
THD (at rated power)	<0.01%
Power Output/Channel (Both channels driven into 4 Ω)	235 Watts, 20Hz to 20kHz
THD (at rated power)	<0.05% @ 1kHz
Damping Factor	>350
Input Sensitivity (For rated power @ max VC)	1.5Vms
Loop Outputs	1.5Vms with 1.5Vms at Inputs
Frequency Response (@ 1 Watt @ 8 Ohms)	9.5 Hz to 100 kHz +/-1.5 dB
Channel Separation	> 80 dB @ 10 kHz
S/N Ratio (Re: Rated Output, IEC A, Source Inputs 1k Ω)	> 120 dB

General

Control Sections

Auto ON Sensitivity / Time	2.8 mV / 6 seconds
Auto OFF Sensitivity / Time	<2.7 mV / 5 minutes

Power Consumption

Standby	3 Watts
ON no signal (idle)	76 Watts
At $\frac{1}{8}$ Rated Power (18.8 Watts/Channel, 8 Ω)	290 Watts
At $\frac{1}{8}$ Rated Power (18.8 Watts/Channel, 4 Ω)	440 Watts
Rear Panel Marked Power Consumption	850 Watts
Line Ratings	120 VAC
Rear Panel Fuse	T10AL/250V

Dimensions

17- $\frac{1}{8}$ " W x 5- $\frac{1}{2}$ " H x 15- $\frac{1}{2}$ " D
*6- $\frac{1}{8}$ " H, including feet

Weight

33 lbs

LIMITED 2-YEAR WARRANTY

Should you have any questions regarding this, or any other Proficient Audio Systems product, please call our service hotline at 877.888.9004. techsupport@proficientaudio.com

We are available to assist you every weekday, except holidays, between the hours of 7:00 a.m. and 5:00 p.m. PST.

Limited Two-Year Warranty

Proficient Audio Systems ("Proficient") warrants to the original retail purchaser only ("you") that this product will be free from defects in materials and workmanship for a period of two years (the "Warranty Period"), subject to the limitations and exclusions set out in this Limited Warranty. This warranty is not transferable to subsequent owners of the product. If you discover a defect in material or workmanship within the Warranty Period, you can obtain warranty service by contacting Proficient during the Warranty Period at 877.888.9004 or techsupport@proficientaudio.com or by sending the product to Proficient at 940 Columbia Avenue, Riverside, CA 92507 or to the dealer from whom you purchased the product. Defective products must be shipped, prepaid and insured, together with proof of purchase. Warranty service requests made without proof of date of purchase will be denied. Freight collect shipments will be refused. It is preferable to ship this product in the original shipping container to lessen the chance of transit damage. In any case, the risk of loss or damage in transit is to be borne by the purchaser.

If, upon examination by Proficient it is determined that the unit is in fact defective, Proficient will, at its option:

- Repair or replace the product at no additional charge; or
- If the model is no longer available and cannot be repaired effectively, replace the unit with a current model of equal or greater value. In some cases where a new model is substituted, a modification to the mounting surface may be required. If mounting surface modification is required, Proficient assumes no responsibility or liability for such modification. Proficient will bear the cost of returning the repaired or replaced product to you, freight prepaid. All replaced parts and product become the property of Proficient Audio Systems. The foregoing is your sole and exclusive remedy for breach of warranty. If the product is not found to be defective, Proficient will contact you to arrange for return of the product to you, at your expense.

EXCLUSIONS:

- This Warranty does not include service or parts to repair damage caused by accident, disaster, misuse, abuse, negligence, inadequate packing or shipping procedures, commercial use, voltage inputs in excess of the rated maximum of the unit, or service, repair or modification of the product by unauthorized dealers. This Warranty also excludes normal cosmetic deterioration caused by environmental conditions.
- This Warranty will be void if:
 - The Serial Number on the product has been removed, tampered with or defaced.
 - The product was not purchased from an authorized dealer.

The foregoing warranties are exclusive and in lieu of all other expressed and Implied warranties. Proficient expressly disclaims all such other warranties, including but not limited to implied warranties of merchantability, fitness for A particular purpose and non-infringement. In no event will Proficient be liable for any incidental or consequential damages arising out of the use or inability to use the product, even if Proficient has been advised of the possibility of such damages, or for any claim by any other party. Notwithstanding the above, if you qualify as a "consumer" under the Magnuson-Moss Warranty Act, then you may be entitled to any implied warranties allowed by law for the Warranty Period. Further, some states do not allow limitations on how long an implied Limited Warranty lasts or allow the exclusion or limitation of consequential damages, so such limitations may not apply to you.

ATTENTION TO OUR VALUED CONSUMERS:

To insure that consumers obtain quality pre-sale and after-sale support and service, Proficient products are sold exclusively through authorized dealers. **Proficient products are not sold online** by Proficient or its authorized dealers, and this warranty is VOID if the products have been purchased from any internet reseller. To determine if your Proficient reseller is authorized, please call Proficient at 877.888.9004 or go to proficientaudio.com.



940 Columbia Avenue, Riverside, CA 92507
877.888.9004 • Fax 951.750.6304 • proficientaudio.com
©2009 Proficient Audio Systems



1301-72200